

# PERMIT

**CITY OF NAPOLEON - BUILDING DEPARTMENT**  
 255 West Riverview Avenue, Napoleon, Ohio 43545 - 419-592-4010

Permit No. 01287 Issued 12-2-86  
date

Job Location 416 S. Perry St.  
address

Lot 20 J.G. Lowes 1st Add.  
sub-div or legal discript

Issued By Eldon Huber  
building official

Owner Flora Melcher  
name tel.

Address 416 S. Perry St.

Agent Bartel's Elec. 533-3421  
builder-eng.-etc. tel.

Address 508 East St.

Description of Use Residential

---

Residential 1  
no. dwelling units

Commercial \_\_\_\_\_ Industrial \_\_\_\_\_

New \_\_\_\_\_ Add'n. \_\_\_\_\_ Alter 1 Remodel \_\_\_\_\_

Mixed Occupancy \_\_\_\_\_

Change of Occupancy \_\_\_\_\_

Estimated Cost \$ 400.00

FEES	BASE	PLUS	TOTAL
<input checked="" type="checkbox"/> BUILDING	5.00	.00	5.00
<input type="checkbox"/> ELECTRICAL			
<input type="checkbox"/> PLUMBING			
<input type="checkbox"/> MECHANICAL			
<input type="checkbox"/> DEMOLITION			
<input type="checkbox"/> ZONING			
<input type="checkbox"/> SIGN			
WATER TAP			
SEWER TAP			
TEMP. ELECT.			
ADDITIONAL PLAN REVIEW	Struct. _____ hrs	Elect. _____ hrs	
TOTAL FEES.....			5.00
LESS MIN. FEES PAID _____			
BALANCE DUE.....			

**ZONING INFORMATION** N.A.

district G.B.	lot dimensions	area	front yd	side yds	rear yd
max hgt	no pkg spaces	no ldg spaces	max cover	petition or appeal req'd	date appr

**WORK INFORMATION:**

Size: Length N.A. Width \_\_\_\_\_ Stories \_\_\_\_\_ Ground Floor Area \_\_\_\_\_

Height \_\_\_\_\_ Building Volume (for demo. permit) \_\_\_\_\_ cu. ft.

Electrical: Replace existing service with new 100 a. overhead  
brief description

Plumbing: N.A.  
brief description

Mechanical: N.A.  
brief description

Sign: N.A. Dimensions \_\_\_\_\_ Sign Area \_\_\_\_\_  
type

Additional Information: \_\_\_\_\_

PAID  
 DEC 2 1986  
 CITY OF NAPOLEON

Date 12-2-86 Applicant Signature John D. Swearingen  
owner-agent

# INSPECTION RECORD

UNDERGROUND			ROUGH-IN						FINAL		
Type	Date	By	Type	Date	By	Type	Date	By	Type	Date	By
<b>PLUMBING</b>	Building Drains		Drainage, Waste & Vent Piping			Indirect Waste			Drainage, Waste & Vent Piping		
	Water Piping								Backflow Prevention		
	Building Sewer		Water Piping			Condensate Lines			Water Heater		
	Sewer Connection								FINAL APPROVAL		
<b>MECHANICAL</b>	Refrigerant Piping		Refrigerant Piping			Chimney(s)			Grease Exhaust System		
			Duct Furnace(s)			Fire Dampers			Air Cond. Unit(s)		
	Ducts/ Plenums		Ducts/ Plenums			<input type="checkbox"/> Radiant Htr(s) <input type="checkbox"/> Unit Htr(s)			Refrigeration Equipment		
			Duct Insulation			Pool Heater			Furnace(s)		
			Combustion Products Vents			Ventilation <input type="checkbox"/> Supply <input type="checkbox"/> Exhst.			FINAL APPROVAL		
<b>ELECTRICAL</b>	Conduits & or Cable		Conduits/ Cable			<input type="checkbox"/> Range <input type="checkbox"/> Dryer			Temp Service Temp Lighting		
	Grounding & or Bonding		Rough Wiring			<input type="checkbox"/> Generator(s) <input type="checkbox"/> Motors			Fixtures Lampholders		
	Floor Ducts Raceways		Service Panel Switchboard			<input type="checkbox"/> Water Htr <input type="checkbox"/> Welder			Signs		
	Service Conduit		Busways Ducts			<input type="checkbox"/> Heaters <input type="checkbox"/> Heat Cable			Electric Mtr. Clearance		
	Temporary Power Pole		Subpanels			<input type="checkbox"/> Duct Htr(s) <input type="checkbox"/> Furnace(s)			FINAL APPROVAL		
<b>BUILDING</b>	Location, Set-backs, Esmt(s)		Exterior Wall Construction			Roof Covering Roof Drainage			Smoke Detector		
	Excavation					Exterior Lath			Demolition (sewer cap)		
	Footings & Reinforcing					<input type="checkbox"/> Interior Lath <input type="checkbox"/> Wallboard					
	Floor Slab		Interior Wall Construction			Fire Wall(s)			Building or Structure		
	Foundation Walls		Columns & Supports			Fireplace Chimney					
	Sub-soil Drain		Crawl Space <input type="checkbox"/> Vent <input type="checkbox"/> Access			Attic <input type="checkbox"/> Vent <input type="checkbox"/> Access					
	Piles		Floor System(s)						FINAL APPROVAL BLDG. DEPT.		
		Roof System			Special Insp Reports Rec'd			Certificate of Occupancy Issued			
<b>ADDITIONAL</b>	<b>INSPECTIONS, CORRECTIONS, ETC.</b>					<b>INSPECTIONS, CORRECTIONS, ETC.</b>					

DEC 5 1980  
 CITY OF WASHINGTON

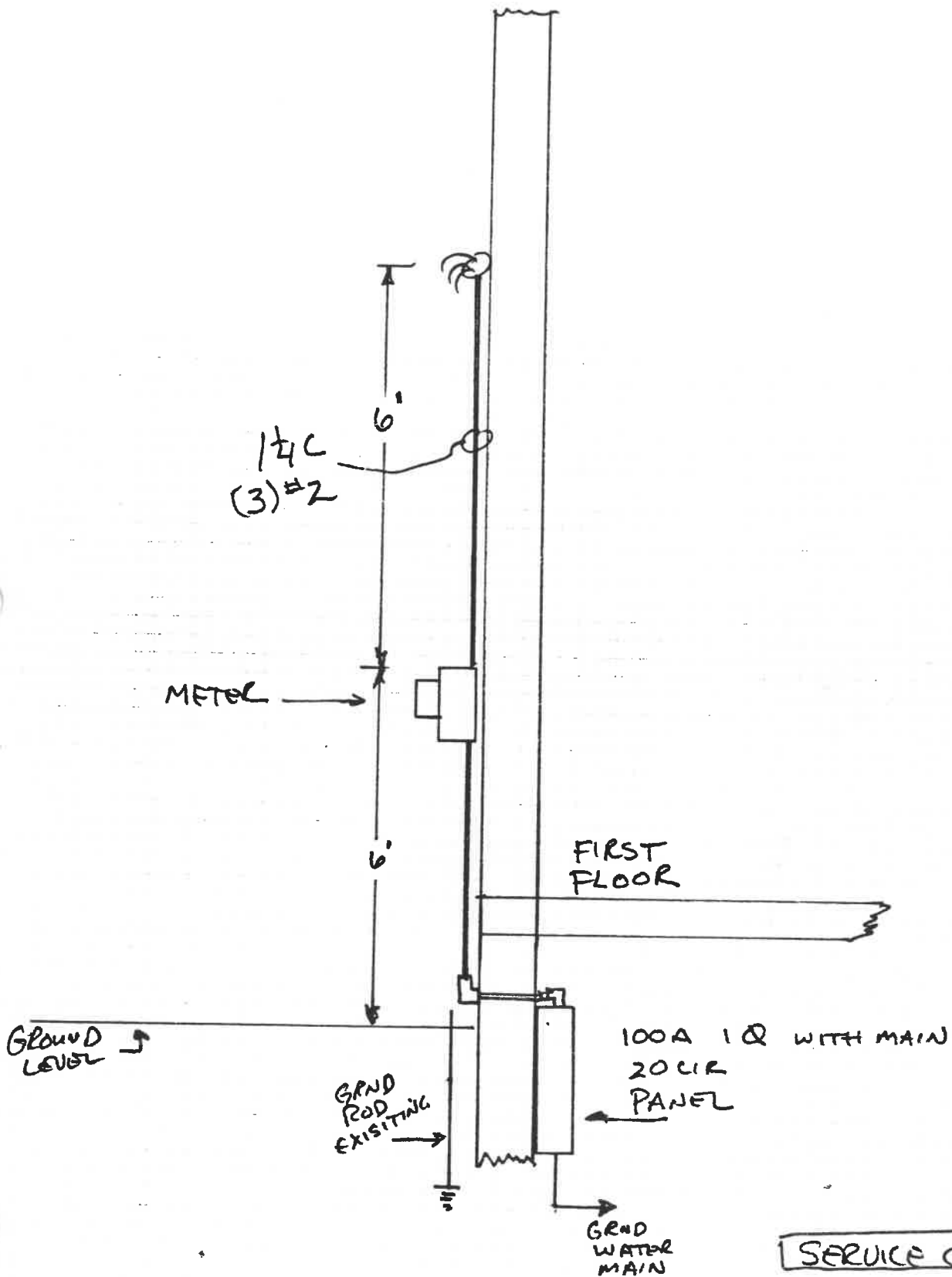

**SERVICE CHANGE**

FLORA MELCHER  
 416 SO. PERRY  
 NAPOLEON, OHIO



# PERMIT

**CITY OF NAPOLEON - BUILDING DEPARTMENT**  
 255 West Riverview Avenue, Napoleon, Ohio 43545 - 419-592-4010

01287

Permit No. [REDACTED] Issued 12-2-86 date  
 Job Location 416 S. PERRY ST. address  
 Lot 20 J.G. LOWES 1ST ADD. address  
 sub-div or legal discript  
 Issued By FH building official  
 Owner FLORA MELCHER name tel.  
 Address 416 S. PERRY ST.  
 Agent DIARTEL'S ELKC 533-3421 tel.  
 builder-eng.-etc.  
 Address 508 EAST ST.  
 Description of Use RESIDENTIAL  
 Residential 1 no. dwelling units  
 Commercial \_\_\_\_\_ Industrial \_\_\_\_\_  
 New \_\_\_\_\_ Add'n. \_\_\_\_\_ Alter X Remodel \_\_\_\_\_  
 Mixed Occupancy \_\_\_\_\_  
 Change of Occupancy \_\_\_\_\_  
 Estimated Cost \$ 400.<sup>00</sup>

FEES	BASE	PLUS	TOTAL
<input type="checkbox"/> BUILDING	\$100	.00	\$100
<input type="checkbox"/> ELECTRICAL			
<input type="checkbox"/> PLUMBING			
<input type="checkbox"/> MECHANICAL			
<input type="checkbox"/> DEMOLITION			
<input type="checkbox"/> ZONING			
<input type="checkbox"/> SIGN			
WATER TAP			
SEWER TAP			
TEMP. ELECT.			
ADDITIONAL PLAN REVIEW	Struct. _____ hrs		
	Elect. _____ hrs		
TOTAL FEES.....			\$5.00
LESS MIN. FEES PAID _____ date			\$5
BALANCE DUE.....			

### ZONING INFORMATION D.A.

district	lot dimensions	area	front yd	side yds	rear yd
<u>G.B.</u>					
max hgt	no pkg spaces	no ldg spaces	max cover	petition or appeal req'd	date appr

### WORK INFORMATION:

Size: Length N.A. Width \_\_\_\_\_ Stories \_\_\_\_\_ Ground Floor Area \_\_\_\_\_  
 Height \_\_\_\_\_ Building Volume (for demo. permit) \_\_\_\_\_ cu. ft.  
 Electrical: REPLACE EXISTING SERVICE WITH NEW 100 A. OVERHEAD  
 brief description  
 Plumbing: N.A. brief description  
 Mechanical: N.A. brief description  
 Sign: N.A. Dimensions \_\_\_\_\_ Sign Area \_\_\_\_\_  
 type

Additional Information: \_\_\_\_\_

Date \_\_\_\_\_ Applicant Signature \_\_\_\_\_  
owner-agent



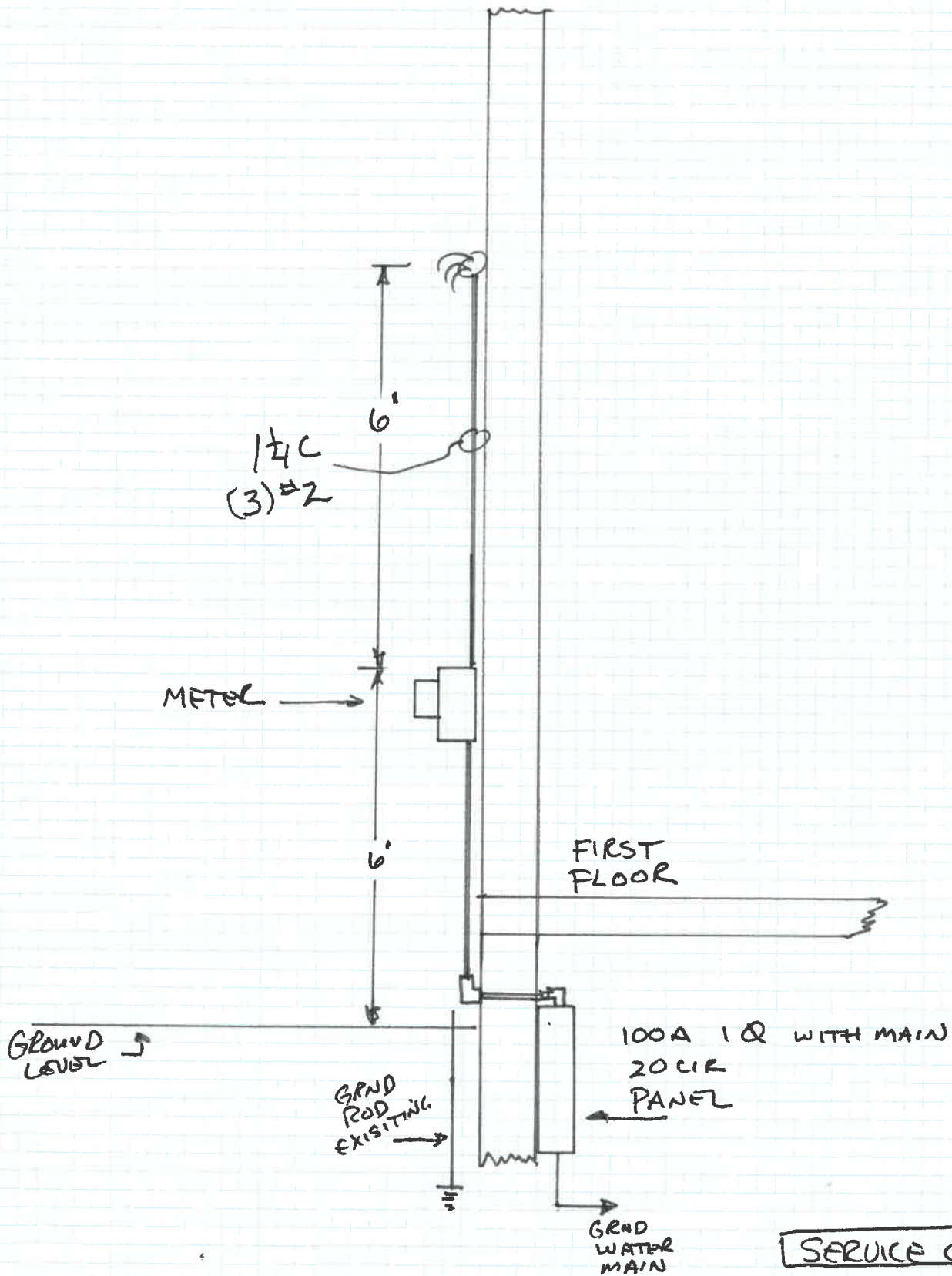

**SERVICE CHANGE**  
 FLORA MELCHER  
 416 SO. PERRY  
 NAPOLEON, OHIO





WATER TAPPING PERMIT

Issued by

The Napoleon Water Distribution Department

255 West Riverview Ave. Napoleon, Ohio 43545 Ph. 592-4010

Permit No. W-0283 Issued \_\_\_\_\_ Received of \_\_\_\_\_ (\$ \_\_\_\_\_).00

(Charge for tapping permit to supply water service to) Lot No. \_\_\_\_\_ Sub Div. \_\_\_\_\_

Street No. \_\_\_\_\_ Tap Size \_\_\_\_\_ \* Cost \$ \_\_\_\_\_ .00 Plumber \_\_\_\_\_

Date completed \_\_\_\_\_ Approved by Jeffrey C. Maibach water distribution dept. \_\_\_\_\_ finance director

Name \_\_\_\_\_ Size of tap 1" Date 11-30-95 Street and No. 416 S. Perry

Old Tap No. 399 New Tap No. 95103 Size and Kind of Main 8" C.I.P.

Location of Main 6' West of center of pavement Depth of Main 5 1/2'

Distance from Hydrant/Valve 152' South of Hyd 101 Distance to Curb Stop from Corp. 29'

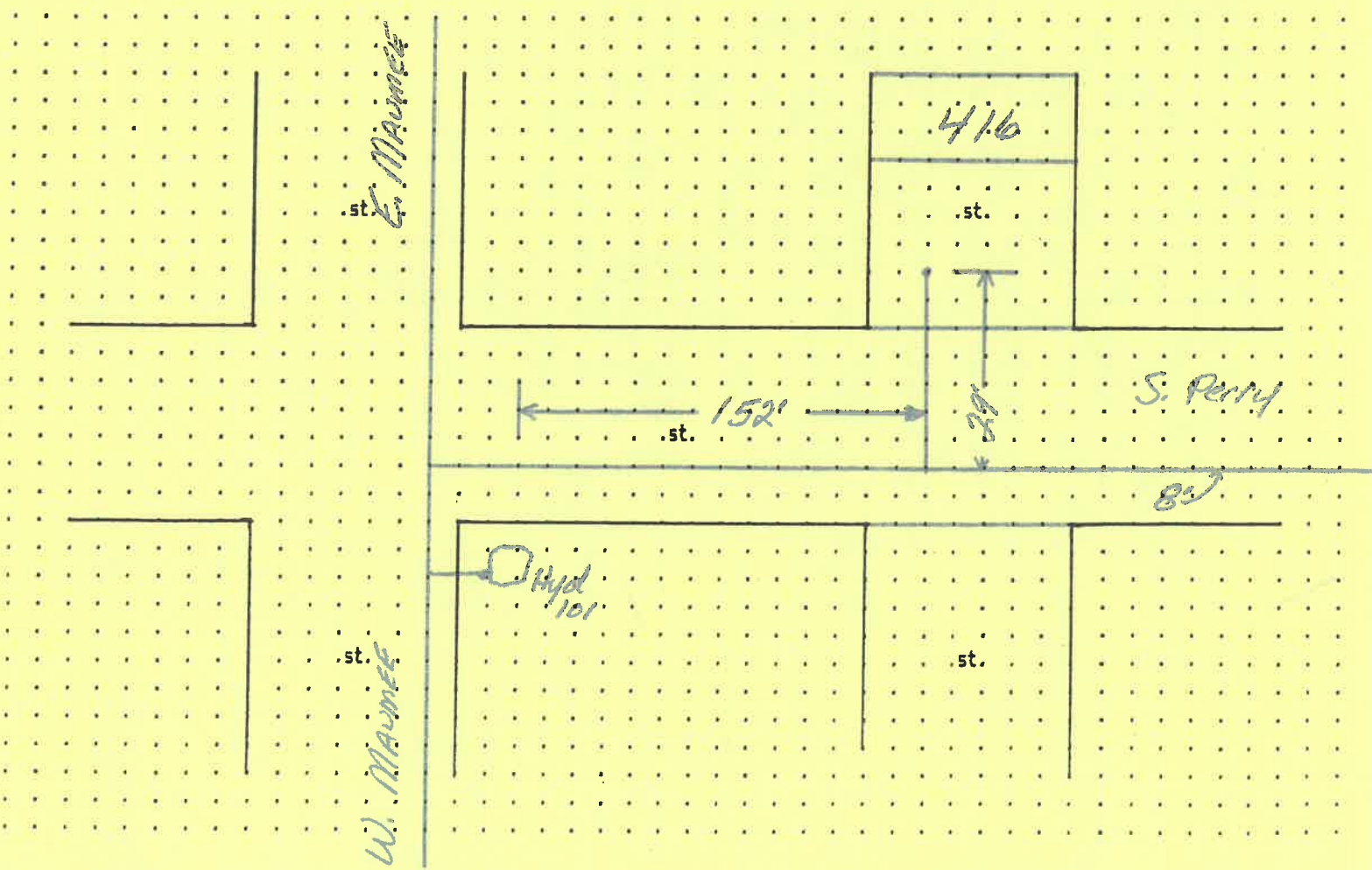

**UNITED STATES DEPARTMENT OF AGRICULTURE**  
**OFFICE OF THE SECRETARY**  
**WASHINGTON, D. C.**

**REPORT OF THE SECRETARY OF AGRICULTURE**  
**ON THE**

**PROGRESS OF THE AGRICULTURAL RESEARCH SERVICE**  
**FOR THE YEAR 1934**

**PRESENTED TO THE HOUSE OF REPRESENTATIVES**  
**IN SENATE AND HOUSE REPORT NO. 100**  
**85th CONGRESS, 1st Session**

**WASHINGTON, D. C.**  
**GOVERNMENT PRINTING OFFICE**  
**1935**

Item	Amount	Funds Available	Amount Expended	Balance
1. Salaries and Wages	\$ 1,200,000.00	\$ 1,200,000.00	\$ 1,150,000.00	\$ 50,000.00
2. Travel	\$ 500,000.00	\$ 500,000.00	\$ 480,000.00	\$ 20,000.00
3. Printing and Stationery	\$ 100,000.00	\$ 100,000.00	\$ 95,000.00	\$ 5,000.00
4. Equipment	\$ 200,000.00	\$ 200,000.00	\$ 180,000.00	\$ 20,000.00
5. Buildings	\$ 300,000.00	\$ 300,000.00	\$ 280,000.00	\$ 20,000.00
6. Miscellaneous	\$ 100,000.00	\$ 100,000.00	\$ 90,000.00	\$ 10,000.00
<b>Total</b>	<b>\$ 2,300,000.00</b>	<b>\$ 2,300,000.00</b>	<b>\$ 2,175,000.00</b>	<b>\$ 125,000.00</b>